

# AIRFLOW™ 3 HP COMBI

## 310–600 ML CARTRIDGE & SACHET DISPENSER



**Rod driven plunger**  
prevents cartridges ballooning

**Air return button**  
retracts plunger

**Glass reinforced nylon handle**  
ergonomically designed for comfort

**Variable speed regulator**  
for precise control  
and smooth material flow

- Regulators**
- Standard: 6.8 bar (100 psi) ●
  - Options available:
  - 3.4 bar (50 psi) ●
  - 5.2 bar (75 psi) ●
  - 8.5 bar (125 psi) ○

Model shown: AirFlow 3 HP Combi 600 mL

### FEATURES

- Variable speed regulator
- Built-in silencer (less than 70 dB)
- Rod driven plunger
- Fitted as standard with a 6.8 bar (100 psi) regulator

### BENEFITS

- For precise control, smooth material flow
- Lowers the noise level
- Prevents cartridges ballooning
- Others are available

### APPLICATIONS



### PRODUCT BY RANGE



# THE AIRFLOW 3 HP COMBI 1-COMPONENT PNEUMATIC DISPENSER DESIGNED FOR USE WITH LOW TO HIGH VISCOSITY SEALANTS AND ADHESIVES. THE VARIABLE SPEED REGULATOR AND PISTON DRIVEN ROD PLUNGER GIVES YOU PRECISE CONTROL.

## SPECIFICATIONS

- Weight: 1.73–1.83 kg / 3.8–4.0 lbs
- Barrel Length: 210–347 mm / 8.3–13.6 in
- Maximum Thrust: 2.5 kN
- Maximum Pneumatic Pressure: 6.8 bar (100 psi)
- Handle Material: Glass Filled Nylon
- Barrel Material: Anodized Aluminum
- Cartridge Capacity: 310 mL (10.5 oz), 400 mL (13.5 oz)
- Sachet Capacity: 310 mL (10.5 oz), 400 mL (13.5 oz), 600 mL (20.3 oz)
- Standard Color: Black/Grey
- Nozzle Dimension: Ø 38 mm / 1.5 in
- Customized versions on demand

## DIMENSIONS (MM/IN)

product	height (h)	length (l)	depth (d)	barrel (b)
Combi HP 310	276 / 10.9	549 / 21.6	82 / 3.2	210 / 8.3
Combi HP 400	276 / 10.9	625 / 24.6	82 / 3.2	248 / 9.8
Combi HP 600	276 / 10.9	831 / 32.7	82 / 3.2	347 / 13.6

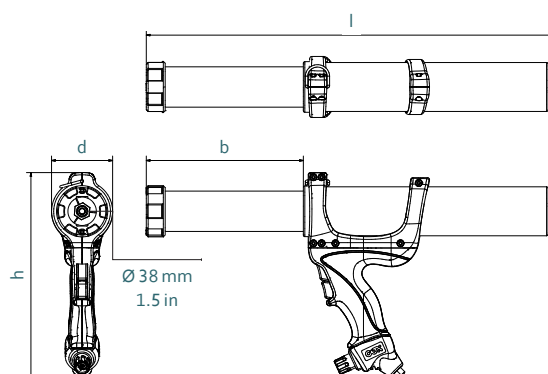

Product	Article number	Packaging
DP1C 310-cm-250-301	181328 (63004-300HP for US)	1 per Box
DP1C 400-cm-250-301	181330	1 per Box
DP1C 600-cm-250-301	181332 (63004-600HP for US)	1 per Box

## MATCHING MIXPAC™ CARTRIDGES



Peeler Cartridge

## COMPATIBLE CARTRIDGES AND SACHETS

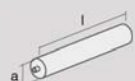

Plastic Cartridge  
310 mL HPDE/PP/PA

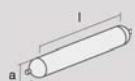

Sachet  
310 mL

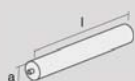

Plastic Cartridge  
400 mL HPDE/PA

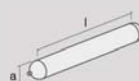

Sachet  
400 mL

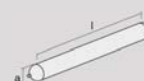

Sachet  
600 mL

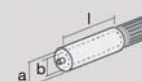

Plastic Cartridge  
150 mL 1:1, 2:1, 10:1 PP

	mm	inch	mm	inch	mm	inch	mm	inch	mm	inch	mm	inch	
l	216.0	8.5	220.0	8.66	256.0	10.1	258.0	10.16	335.0	13.2	117	4.6	
a	Ø 48.2	Ø 1.8	Ø 50.0	Ø 1.97	Ø 49.0	Ø 1.9	Ø 50.0	Ø 1.97	Ø 50.0	Ø 2.0	Ø 50.0	Ø 1.9	
											1:1 b	Ø 32.0	Ø 1.2
											2:1 b	Ø 26.0	Ø 1.0
											10:1 b	Ø 14.3	Ø 0.5

## CONVERSION KITS

Peeler Front Cap

## MATCHING ACCESSORIES

Nozzles on pages 98–102.